

# 62 Super Sport

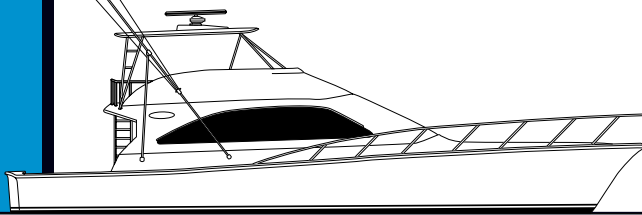

30 Years of Family Boat Building Heritage

## SPECIFICATIONS

EFFECTIVE AUGUST 1, 2007

Length	. . . . . 62'0"	. . . . . 18.90 m
Beam	. . . . . 17'5"	. . . . . 5.31 m
Draft	. . . . . 5'0"	. . . . . 1.52 m
Freeboard, Bow	. . . . . 6'7"	. . . . . 2.01 m
Freeboard, Stern	. . . . . 3'6"	. . . . . 1.07 m
Fuel Capacity	. . . . . 1,450 gal.	. . . . . 5,488 l
Water Capacity	. . . . . .255 gal.	. . . . . .965 l
Displacement	. . . . . 82,000 lb.	. . . . . 37,195 kg
Height (waterline to top of hardtop)	. . . . . 17'11"	. . . . . 5.46 m
Headroom (most areas)	. . . . . 6'5"	. . . . . 1.96 m
Sleeping Capacity	. . . . .	. . . . . 6 - 8

## STANDARD EQUIPMENT

- ENGINE ROOM AND PROPULSION**  
 Sound & heat insulated engine room  
 Anti-fouling bottom paint  
 Awlgrippd engine room, lazarette & bilges  
 Twin diesel, water cooled engines with lubricating oil & recovery systems  
 Engine synchronizer  
 Engine hour meters  
 Alternators  
 Fuel filters – main engines & generators  
 Propellers (2) – Nibral  
 Shafts (2) – Aquamet 22  
 Bronze rudders & struts  
 Trim tabs  
 External sea strainers – large wedge type  
 Fiberglass mufflers  
 Automatic fire extinguisher system  
 Electric oil exchange system – engines & generator  
 Heat recovery bottles – engines & generator  
 Electric fuel priming pump  
 Fuel transfer pump  
 Engine room blowers (2) & fans (2)  
 Fresh water spigot in engine room  
 Electrical outlet
- ELECTRICAL SYSTEM**  
 \*Generators – Twin 12.5 kW – water cooled  
 50' Shore cords (2) – 50A/240V, with automatic cord reels  
 Electrical outlets, 120V  
 Batteries (8) – heavy duty, deep cycle/cranking battery (two banks)  
 Dyna plate ground system  
 Battery parallel system  
 Automatic battery charger  
 Internal bonding system  
 Electrical panel with circuit breakers, voltmeters & battery condition indicator  
 Zoned air conditioning with reverse cycle heating  
 Zinc anodes  
 SSB radio ground screen  
 12V step-down transformer for flybridge
- LIGHTING SYSTEM**  
 Navigation lights  
 Cockpit courtesy lighting  
 24V & 120V lighting throughout  
 Engine room lighting – 24V & 120V  
 Back lighting on electrical panel & flybridge instruments
- WATER SYSTEM**  
 Hot water heater – 20 gallon †  
 Water pressure system
- Enclosed shower sump pump – 24V (automatic)  
 Faucets  
 Central main drain aft  
 VacuFlush head system  
 Holding tank – 42 gallons †  
 Dockside water connection
- DECK AND OUTFITTING**  
 Rope locker with freshwater washdown  
 Rope deck pipe  
 Aluminum bow rail with pennant staff  
 Window rails – aluminum, powdercoated  
 Forward deck hatch  
 Cleats (12") – 3 bow, 4 spring, 2 stern  
 Hawse pipes (2)  
 Docklines (6) – 35' x 5/8"  
 Fenders (2) – 12" x 34"
- SAFETY AND NAVIGATION**  
 Anchor – 65 lb Danforth  
 Anchor chain – 5' vinyl coated  
 Anchor line – 300' x 5/8" nylon  
 Fog bell  
 Deluxe air horns  
 Fire extinguishers – 2 1/2 lb portable (3) & 5 lb portable (1)  
 Carbon monoxide & smoke detector  
 First aid kit  
 Olin flare kit  
 Life jackets – Type 1 (6) & 20" ring buoy (1)  
 VHF radio with antenna  
 Furuno RD-30 System for water depth & temperature  
 Compass – 5" flush mount  
 Power steering  
 Electronic controls with Palm Beach style handles (open flybridge)  
 Seacocks (quick-action ball valve) – on all through-hull fittings below waterline  
 Fuel shutoff valves (quick-action ball valve)  
 Engine alarm system  
 Bilge pumps – automatic (4)  
 High bilge water alarm  
 Bilge blowers – 4" (2)  
 Tinted safety glass
- COCKPIT**  
 Molded fiberglass, self bailing  
 Molded live baitwell in transom  
 Rod holders (4)  
 Seawater & freshwater washdowns  
 Insulated fishbox with pumpout (1)  
 Refrigerated fishbox with pumpout (1)  
 Bait prep center with tackle drawers, sink & freshwater spigot

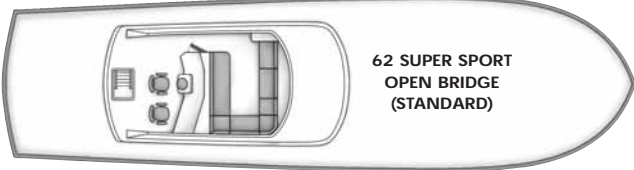

62 SUPER SPORT  
OPEN BRIDGE  
(STANDARD)



62 SUPER SPORT  
ENCLOSED BRIDGE  
(OPTIONAL)

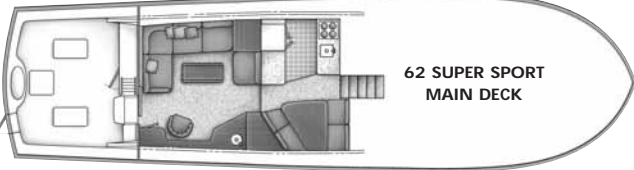

62 SUPER SPORT  
MAIN DECK

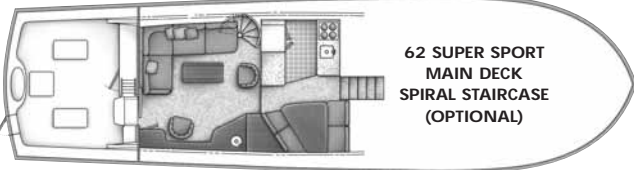

62 SUPER SPORT  
MAIN DECK  
SPIRAL STAIRCASE  
(OPTIONAL)

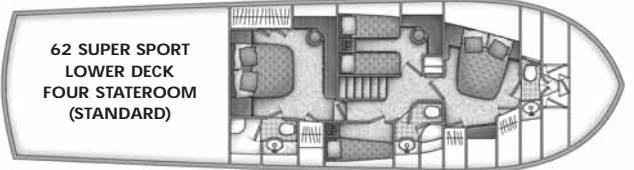

62 SUPER SPORT  
LOWER DECK  
FOUR STATEROOM  
(STANDARD)

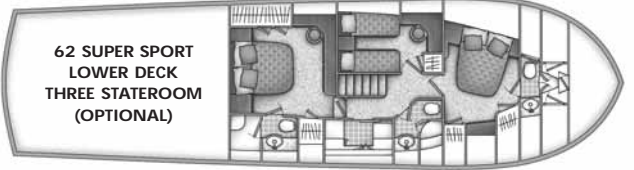

62 SUPER SPORT  
LOWER DECK  
THREE STATEROOM  
(OPTIONAL)

## POWERPLANTS

- Twin MAN V12 1550 CRM Diesels
- Twin CAT C32 1675 MHP Diesels

\*Generator is not intended to supply power for all standard and optional accessories. Load must be limited to generator output rating. †Capacities of tanks are estimates and useable volume will vary depending upon installation requirements and conditions. Note: Floorplans may contain options or other features not covered by the base price. Ocean Yachts reserves the right to make changes to its standard or optional equipment list or to what is shown in visual representations of its models in advertising and sales materials. Ocean Yachts may do so at any time and without prior notice. Ocean Yachts also reserves the right to make such changes without incurring any obligations to equip or modify models manufactured prior to the effective date of such change.

## STANDARD ACCOMMODATIONS

Freezer  
Side lockers  
Insulated drink box (in salon entry step)  
Stereo speakers (2)  
Lazarette access  
Engine room access  
Transom door & hinged gate  
Under-hatch dunnage bins (2)  
Boarding step box

**OPEN FLYING BRIDGE (STANDARD)**  
Fully instrumented, molded fiberglass  
open flying bridge  
Hardtop with molded-in spreader lights &  
3-sided EZ2CY enclosure  
Pompanette Tournament Series teak  
ladderback helm & companion chairs (2)  
Aluminum ladder & aft safety rail with  
6 rocket launchers  
Chart light  
Electrical sub-panel  
Electrical outlet (120V)  
Accessory outlet (12V)  
Fuel gauges  
Lounge seating with pleated cushions  
& storage  
Rod storage

**ENCLOSED FLYING BRIDGE (OPTIONAL)**  
Fully instrumented, molded fiberglass  
enclosed flying bridge  
Spreader lights  
Pompanette Prestige Series helm &  
companion chairs (2)  
Aluminum ladder & aft safety rail with  
6 rocket launchers  
Electrical sub-panel  
Electrical outlets (120V)  
Fuel gauges  
L-shaped lounge seating with table  
Furuno RD-30 Display  
Aluminum door  
Tinted safety glass  
Windshield wipers & defogger  
Air conditioning with reverse cycle heat  
15" LCD flatscreen TV, DVD player & remote  
Spiral staircase to salon  
Aft deck steering station with electronic controls  
Headliner, valances & carpeting  
Phone outlet  
Wet bar with refrigerator/icemaker & storage  
Courtesy lighting  
Standard generators upgraded to twin 15.0 kW

**SALON**  
Aluminum sliding door with security lock  
Carpeting, with canvas runner  
Upholstered panels & valances  
Headliner  
Silhouette blinds  
U-shaped lounge seating with rod storage  
Designer chair  
Central vacuum system  
Zoned air conditioning with  
reverse cycle heating  
Icemaker  
Retractable 40" LCD flatscreen TV  
Bose Lifestyle 38 CD/DVD stereo with remote  
Cocktail table with storage  
Personal choice interior décor selection (custom)  
Phone outlet

**GALLEY/DINETTE**  
Corian® countertop & sink  
Amtico® flooring  
Convection/microwave oven  
Recessed 4-burner range  
Trash compactor  
Upright refrigerator/freezer  
Booth style dinette with adjustable hi-gloss table  
Spacious drawers & cabinets  
Ground fault electrical outlets  
Instant hot water faucet  
Exhaust blower  
Water tank gauge

**MASTER STATEROOM**  
Queen berth with innerspring mattress  
& drawer storage  
Bedspread, pillows (2), shams (2)  
& fitted sheet set  
Nightstands (2) with drawers  
Hanging lockers (2)  
32" LCD flatscreen TV with DVD player  
& remote  
Bose SA-3 Stereo System  
Private head access  
Vanity with mirror & stool  
Drawers & cabinets

**VIP STATEROOM (FORWARD)**  
Full berth with innerspring mattress & drawers  
Bedspread, pillows (2), shams (2)  
& fitted sheet set  
Nightstands (2)  
Hanging lockers (2)  
20" LCD flatscreen TV with DVD player & remote  
CD player with AM/FM stereo & speakers  
Private head access  
Cabinets  
Deck hatch

**GUEST STATEROOM (PORT)**  
Side by side twin berths with 5" foam mattresses  
with zippered covers & drawer storage  
Pillows (2), shams (2) & fitted sheet set  
Hanging locker  
Nightstand  
Cabinets  
15" LCD flatscreen TV with DVD player  
& remote  
CD player with AM/FM stereo & speakers  
Vanity with stool & mirror

**CREW STATEROOM (STARBOARD)**  
Raised single berth with 5" foam mattress  
& zippered cover  
Pillow (1), sham (1) & fitted sheet set  
Hanging locker

**UTILITY ROOM (OPTIONAL)**  
Washer & dryer  
Cabinets

**MASTER, GUEST, AND CREW HEADS**  
Private showers with automatic enclosed  
sump pumps & overhead lighting  
Vanities with Corian® countertops & sinks  
Mirrored medicine cabinets  
VacuFlush heads  
Amtico® flooring  
Towel bars  
Exhaust blowers

Lighting – 24V & 110V  
Ground fault outlets – 110V  
Storage

## 62SS OPTIONAL EQUIPMENT

### ELECTRICAL

- 24V bow thruster
- Outlet – extra 110V duplex, TV outlet, phone jack (ea.)
- Twin generator upgrade to 15kW (required for F/B Air)

### DECK & OUTFITTING

- Bow pulpit with anchor roller
- Lewmar Concept III windlass (with pulpit option only)
- Swim platform
- Swim ladder – two step folding
- Teak coverboards
- Teak coamings
- Teak salon entry steps
- Teak cockpit
- Gelcoat hull color (ice blue, aqua mist, or fighting lady yellow)
- Custom gelcoat hull color (to be approved by Ocean)
- Spare propellers
- Sea recovery watermaker
- Emergency bilge valves (ea.)
- Prop Smith – 3 1/2" shaft size

### FLYING BRIDGE

- Hatch in hardtop (ea.)
- Upper vents in enclosure (ea.)
- Aft enclosure (open flybridge)
- Air conditioning with reverse cycle heat (open flybridge)
- CAT electronic controls with Palm Beach style handles (single station)
- VHF radio compartment recessed in hardtop (open flybridge)
- Electric leaser reels recessed in hardtop (Miya Epoch US-Super 9)
- Enclosed flybridge package (includes spiral staircase to salon)
- Clear flybridge carpet cover (enclosed flybridge)

### FISHING EQUIPMENT

- Rod holders (extra, each)
- Rupp riggers with double box spreaders, 39" poles & flybridge release (pair)
- Rupp center rigger
- Eskimo Icemaker
- Trolling Valves

### INTERIOR

- Sofa bed
- Amtico® flooring at salon entrance
- Amtico® flooring under dinette (in lieu of standard)
- Whisper walls (companionway only)
- Clear salon carpet cover (in lieu of standard)
- Steps & companionway runner (canvas)
- Under-counter drawer style refrigerator (1) & freezer (1) (in lieu of upright)
- Oven (can only be used with 4-burner stove)
- Dishwasher (can only be used with 2-burner stove)
- Optional laundry/utility center (in lieu of crew stateroom)

### DECOR

- Accessory package
- Cherry interior – satin finish (in lieu of standard teak)
- Hi-gloss finish for teak or cherry (price does not include cherry interior upgrade)

### DELIVERY PREPARATION

- Cost of fuel at time of delivery

Optional equipment prices valid on boats completed at the Ocean Yachts factory no later than July 31, 2008.  
Fuel extra at delivery. Lettering of transom with original order.

**POWERED BY CAT<sup>®</sup> Marine Power**



The Best Part Of Life Is Spent On An Ocean<sup>SM</sup>

Ocean Yachts, Inc., PO Box 312, Egg Harbor City, New Jersey 08215  
609-965-4616 / Fax 609-965-4914 / oceanyachtsinc.com  
info@oceanyachtsinc.com



Every Ocean Yacht is backed by a transferable 5-Year Limited Structural Hull Warranty. Five-Year Engine and Generator Limited Warranties are extended by the respective manufacturers. Ocean was the first manufacturer in the industry to offer such owner protection and peace of mind.

Ocean hulls are NMMA certified, meeting or exceeding the materials and construction standards of the National Marine Manufacturers Association. Warranty program terms and conditions are available upon request.