



70 SUPER SPORT

SPECIFICATIONS

Effective August 1, 2003

Length70'0"21.33 m
Beam19'8"6.0 m
Draft5'0"1.52 m
Freeboard, Bow7'2"2.18 m
Freeboard, Stern3'8"1.10 m
Headroom, most areas6'6"1.98 m
Fuel Capacity†1,865 gal.7,059 l
Water Capacity†370 gal.1,400 l
Displacement112,000 lb50,803 kg
Height (waterline to top of hardtop)18'4"5.59 m
Sleeping Capacity9

POWERPLANTS

- Twin MTU Series 12V2000 (1500 BHP) Diesels
- Twin CAT C30 (1570 MHP) Diesels
- Twin MTU Series 16V2000 (1800 BHP) Diesels

STANDARD EQUIPMENT

ENGINE ROOM AND PROPULSION

- Fully sound and heat insulated engine room
- Dual fuel filters, main engines
- Fuel filter, generator
- Engine hour meter
- Engine synchronizer
- Alternators
- External sea strainers, large wedge type
- Automatic fire extinguisher system in engine room
- Automatic bilge pumps
- Fiberglass mufflers
- Fresh water spigot in engine room
- Engine room blowers
- Engine room fans
- Sea valves – ball type, on all underwater through-hull fittings
- Shafts (2), Aquamet 22
- Stainless steel rudders
- Bronze struts with bearings
- Propellers (2), Nibral
- Trim tabs with controls on flybridge
- Electric oil exchange system – engines, transmissions and generator
- Heat recovery bottles, engine and generator
- Fuel filter priming pump
- Fuel crossover pump
- Anti-fouling bottom paint
- Awlgrip engine room

- Closet lights
- Engine room lights – 24V and 110V
- Back lighting on electrical center panel and flybridge instruments

WATER SYSTEM

- Hot water heater
- Washer and dryer
- Pressure water system – 240V
- Shower sump pump – 24V automatic
- Faucets
- Central main drain aft eliminates most side through-hull fittings
- Vacu Flush toilet system
- Dockside water connections and fresh water spigot
- Holding tank

DECK AND OUTFITTING

- Handrails, aluminum
- Docklines – 40' nylon (6)
- Cleats – 12" stainless – stern (2), bow (2) and springline (4)
- Hawse pipes (2)
- Cabin door hooks
- Forward deck hatch
- Fenders
- Cockpit boarding step box
- First quality teak solids and trim
- White side window handrails

SAFETY AND NAVIGATION

- Anchor – 85 lb.
- Anchor line – 300' with 10' chain lead
- Air horns, deluxe
- Fire extinguishers – 21/2 lb. portable (4) and 5 lb. (1)
- Fire and smoke detectors (5), interconnected
- First aid kit
- Life jackets – Type 1 (8) and 20" ring buoy (1)
- Olin flare kit
- Bow rail, aluminum
- Bridge rail with ladder, aluminum
- VHF radio with antenna
- Compass, flush mount
- Fuel shutoff valves, quick action ball type
- Seacocks – quick action ball type on all through-hull fittings below waterline
- Bilge pumps, automatic
- Hydraulic power steering
- Electronic controls with trolling valves
- Engine alarm system
- High bilge water alarm
- Bonding throughout

ELECTRICAL SYSTEM

- *Generator, 32.0 KW – fresh water cooled
 - Heavy duty batteries with automatic battery chargers and parallel system
 - Dyna plate ground system
 - Shorelines (2) – 240V-50A with automatic cord reel and twin ISO boost transformers
 - Electrical outlets – 120V duplex
 - Electrical control and distribution panels with circuit breakers, voltmeters and battery condition indicator
 - Zoned air conditioning with twin chillers
 - Zinc anodes
 - SSB radio ground screen
- ### LIGHTING SYSTEM
- Navigation lights
 - Cockpit courtesy lighting
 - 24V and 110V fixtures/receptacles
 - Overhead lights
 - Reading bunk lights

*Generator is not intended to supply power for all standard and optional accessories. Load must be limited to generator output rating.

†Capacities of tanks are estimates and useable volume will vary depending upon installation requirements and conditions.

Note: Floorplans may contain options or other features not covered by the base price. Ocean Yachts reserves the right to make changes to its standard or optional equipment list or to what is shown in visual representations of its models in advertising and sales materials. Ocean Yachts may do so at any time and without prior notice. Ocean Yachts also reserves the right to make such changes without incurring any obligations to equip or modify models manufactured prior to the effective date of such change.

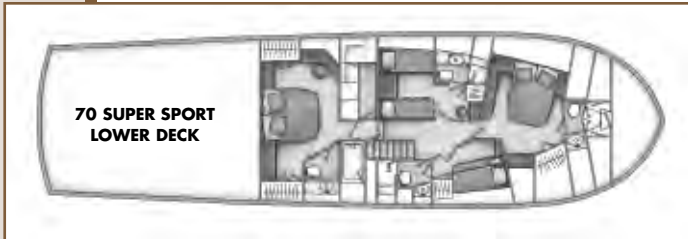
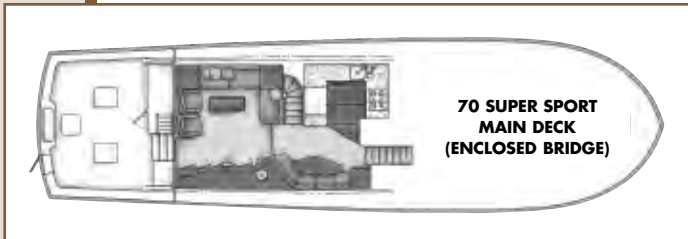
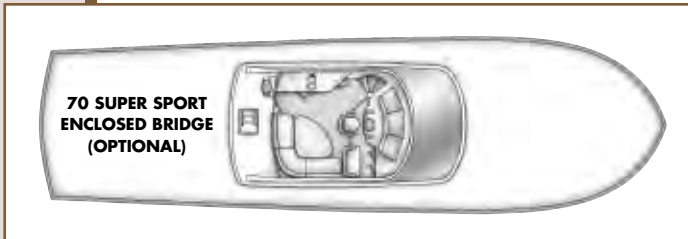

STANDARD ACCOMMODATIONS

COCKPIT

Molded fiberglass, self-bailing
Rod holders (4)
Cockpit side lockers
Tackle locker
Transom live baitwell
Refrigerated fish box with pump
Transom gate and hinged stern door
Door to engine room
Boarding step
Lights in overhang
Seawater washdown
Freshwater washdown
Bait center with freezer, sink with fresh water spigot, and bait cutting board
Tinted aft salon window and door
Lazarette access

ENCLOSED FLYING BRIDGE (Standard)

Fully enclosed fiberglass bridge with entry door, windows, wind shield wipers, air conditioning, ladder, safety rail and storage lockers
Lounge seating with table
Color TV/DVD combo
Fully instrumented forward control station
Adjustable Stidds helm chair
Double-wide companion seat on storage box
Upgraded carpeting
Headliner
Upholstered valances
Phone jack
Extended aft hardtop overhang
Outside steering station with electronic controls
All wiring with circuit breakers for electronics
Weatherproof duplex outlet – 120V
Wet bar with refrigerator, icemaker and storage
Spreader lights
Courtesy lighting
Lewmar hatches in hardtop (2)

OPEN FLYING BRIDGE (Optional)

Fiberglass molded bridge with ladder, safety rail and storage lockers
Custom fiberglass hardtop with three-sided EZ2CY enclosure, (2) molded-in teaser reels, and spreader lights
International chairs (2) – helm, with starboard companion
Wrap-around seating with sleeping area and rod storage
Teak pod-style helm with large drop-in electronics box and storage
Refrigerator
All wiring with circuit breakers for electronics
Weatherproof duplex outlet – 120V

SALON

Carpet runner
Teak paneled bulkheads
Aluminum sliding door with lock
Upgraded carpeting
Designer sofa with rod storage
Custom table – high-low, hi-gloss
Wet bar with icemaker and storage
Spiral staircase to bridge (enclosed F/B only)
Bose Lifestyle stereo system
Color TV with remote and antenna
DVD with remote
Designer decor selection
Central vacuum system
Upholstered chairs (2)
Zoned air conditioning
Headliner
Silhouette blinds
Valance boards and panels

DINETTE

Tinted safety glass
Sea phone with inlet, cord and jacks (4)
24V and 110V lighting
Engine access hatches
Push-button hardware
Dimmer switches

GALLEY/DINETTE

Dishwasher
Convection/microwave oven with fan
Water tank level gauge
Trash compactor
Instant hot water faucet
Range – 4 burner, 220V with oven
Refrigerator and freezer – 120V
Custom-tile flooring
Duplex electrical outlets
Spacious drawers and cabinets
Corian® counter top and sink
Adjustable hi-gloss dinette table with upholstered stool

MASTER STATEROOM

King berth with drawer storage
Upgraded carpeting
Mattress, innerspring
Set of fitted sheets (1)
Bedspread and shams (2)
Pillows (2)
Light fixtures – 24V and 120V
Full length mirror
Nightstands with drawers
Headliner
Dimmer switches
Private head access
Drawers for clothes storage
Overhead cabinets
Hanging locker
Bose stereo system
Air conditioning
Color TV with DVD
Vanity with stool
Phone jack
Teak panel entrance door

VIP STATEROOM

Queen berth with drawer storage
Bedspread and shams (2)
5" innerspring mattress
Set of fitted sheets (1)
Upgraded carpeting
Light fixtures – 24V and 120V
Nightstands (2)
Vanity with stool
Hanging locker
Headliner
Drawers for clothes storage
Overhead cabinets
AM/FM stereo with CD
Color TV with DVD
Air conditioning
Telephone jack
Private head access

GUEST AND CREW STATEROOM

Upgraded carpeting
Headliner
Twin flex berths with drawer storage, 5" polyfoam mattresses and covers. Converts to full size single berth (Guest)
Over/under bunks (Crew)
Overhead cabinets
Set of fitted sheets (1)
Quilted mattress covers and shams (2)
Light fixtures – 24V and 120V
Teak panel entrance door
Hanging locker
Drawers for clothes storage
Color TV/DVD combo (Guest)
Vanity with stool (Guest)
Full length mirror (Guest)
AM/FM stereo with CD player

MASTER AND GUEST HEADS

Custom wall covering
Custom-tile flooring
Headliner
Corian® countertop
Stall shower with door and automatic sump pump and light
Bathtub (Master)
Medicine cabinet with mirror
Set of towels (1)
Linen storage
Exhaust blower
Designer towel bars and fixtures

Vacu Flush heads
Light fixtures – 24V and 120V
Duplex outlets – 120V
Teak panel entrance door
Overhead screened hatch
Macerator pump

UTILITY CENTER

Washer and dryer
Freezer
Storage
Cabinet storage

OPTIONAL EQUIPMENT

ELECTRICAL

- 24V bow thruster
- Outlet – extra 110V duplex, TV outlet, phone jack
- Dual 15 K.W. generators with sound shield (in lieu of standard)

ELECTRONICS

- Transducer – customer supplied (no fairing block)
- Transducer – customer supplied (with fairing block)

DECK AND OUTFITTING

- Swim platform
- Swim ladder, 2-step folding
- Full cockpit cover, Dacron
- Teak cockpit
- Teak coverboards
- Emergency bilge valves
- Lewmar Concept III windlass (with pulpit option only)
- Bow pulpit and rail
- Eskimo icemaker

FISHING EQUIPMENT

- Rod holders, flush mount extra
- Rupp center rigger
- Rupp riggers with triple box spreaders, F.B. release with 41' poles (pair)

FLYING BRIDGE

- Additional Lewmar hatch in hardtop
- Aft enclosure (open flybridge model)

SALON AND INTERIOR

- Full clear salon cover
- Steps and companionway runner
- Install standard VHF radio in salon
- Maple Interior

INTERIOR DECOR

- Accessory package

DELIVERY PREPARATION

- Cost of fuel at time of delivery

Optional equipment prices valid on boats completed at the Ocean Yachts factory no later than July 31, 2004.

Fuel extra at delivery. Lettering of transom with original order.

POWERED BY

CAT Marine Power



The Best Part Of Life Is Spent On An OceanSM

Ocean Yachts, Inc.

PO Box 312, Egg Harbor City, New Jersey 08215

609-965-4616 / Fax 609-965-4914

www.oceanyachtsinc.com